

## INCLUDED PARTS

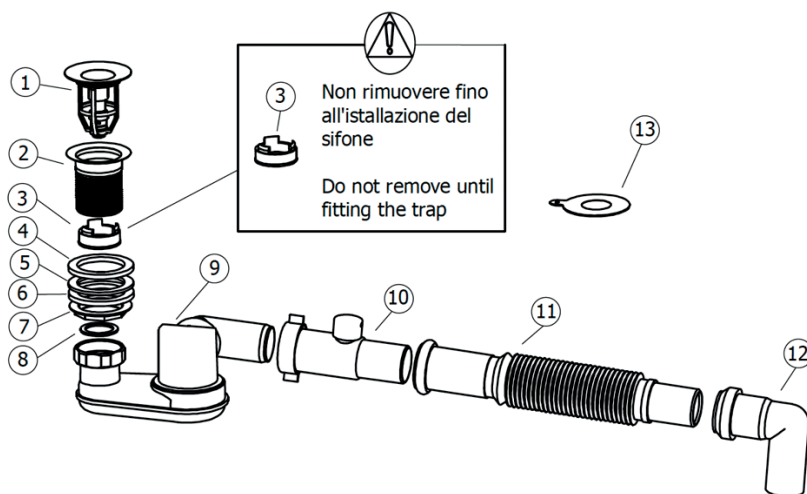

## ART. Descrizione

- 1 Cestello con Troppo Pieno integrato
- 2 Corpo Piletta 1"1/2
- 3 Tappo di protezione
- 4 Guarnizione spugna D.70x48x4
- 5 Guarnizione PVC D.70x48x5
- 6 Guarnizione PVC D.70x48x3
- 7 Controdado ott. crom.1"1/2
- 8 Guarnizione piatta D.40
- 9 Sifone per vasca
- 10 Valvola aspirazione
- 11 Tubo flessibile estensibile
- 12 Curva
- 13 Tappo silicone

## ART. Description

- 1 Basket with Automatic Overflow
- 2 Drain holder 1" 1/2
- 3 Protection cap
- 4 Sponge washer
- 5 Rubber washer
- 6 Rubber washer
- 7 Brass nut
- 8 Flat washer
- 9 Trap
- 10 Air admittance valve
- 11 Flexible pipe
- 12 Elbow
- 13 Silicone cover

# PIL37 \_REV10

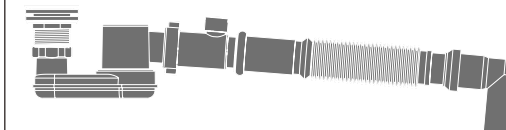

## PIL37/CONNECTIONS

AISI 304 STAINLESS STEEL

Piletta per vasca con troppopieno integrato e mantenimento livello acqua, completa di sifone

*Drain for bathtub with integrated overflow and water level maintenance, complete with siphon*

CEADESIGN STUDIO

## MANUTENZIONE / MAINTENANCE

NON UTILIZZARE DO NOT USE		acido clorico e muriatico <i>cloric and muriatic acid</i>
		acido fluoridrico <i>hydrofluoric acid</i>
		ipoclorito di sodio <i>chlorine bleach</i>
UTILIZZARE TO USE		detergente a pH neutro <i>neutral pH detergent</i>

Questi disegni sono proprietà di CEADESIGN SRL s.u. pertanto non potranno essere utilizzati e/o comunicati a terzi, anche in forma parziale, senza preventiva autorizzazione. CEADESIGN SRL s.u. si riserva il diritto di apportare modifiche ai disegni al fine di migliorare il prodotto.

*CEADESIGN SRL s.u. has the property rights on these drawings, therefore they cannot be used and/or transferred to third party, even in partial form, without any prior authorization. Furthermore CEADESIGN SRL s.u. reserves the right to apply any change to these drawings in order to upgrade the product.*

# CEA

ceadesign.it

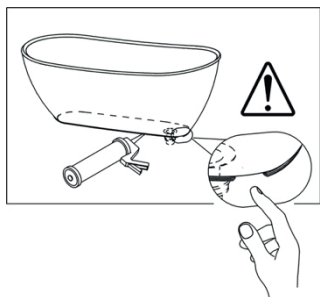
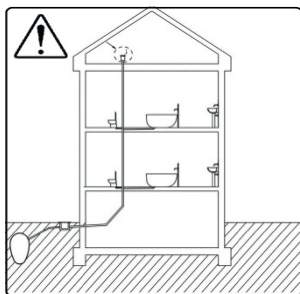

Deve essere utilizzato uno scarico ventilato. Assicurarsi che la vasca non sia completamente sigillata affinché la valvola d'aspirazione abbia una presa d'aria / *Must use a ventilated waste system and ensure the bath is not fully sealed o allow an air intake to the air admittance valve*

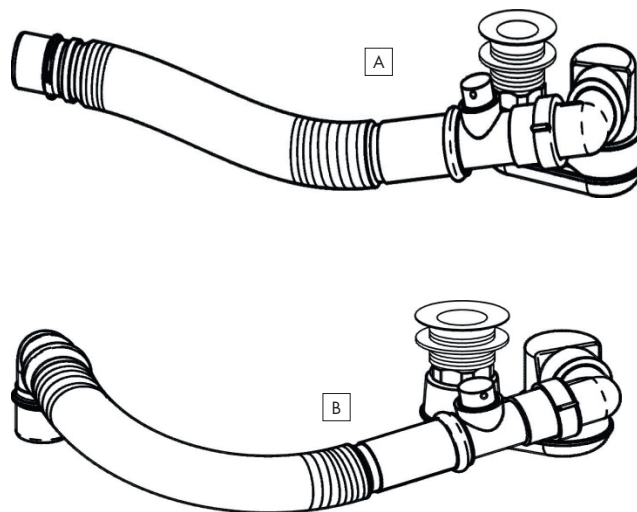
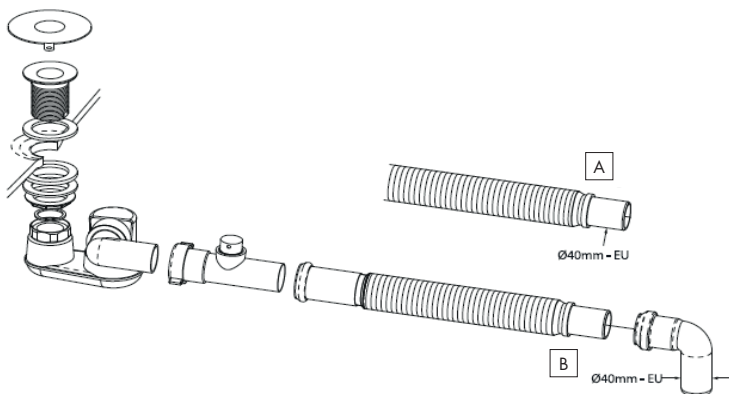
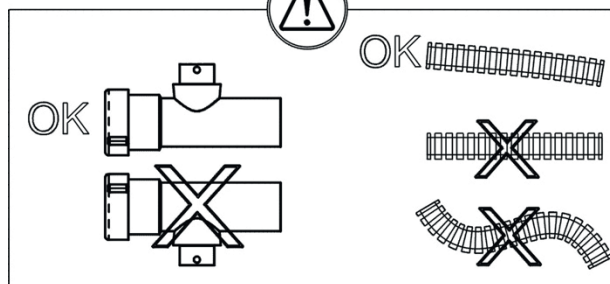
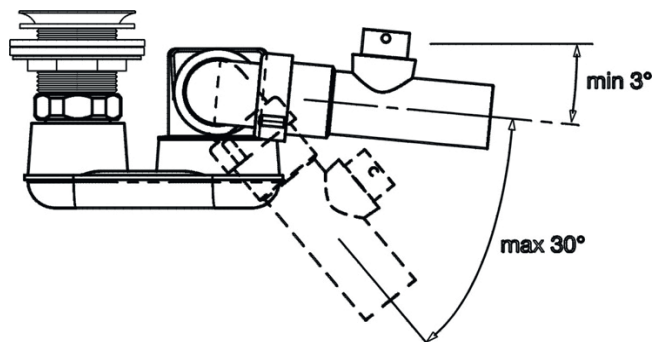

PIL37 \_REV10

CAPACITÀ DI SCARICO / DRAINAGE CAPACITY

l/min	gpm
24	6.3

CEQ

ceadesign.it

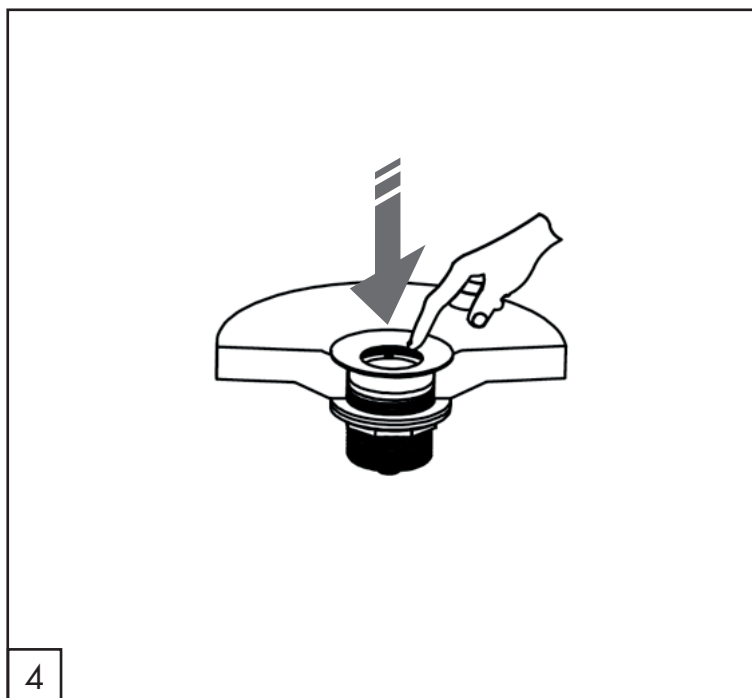
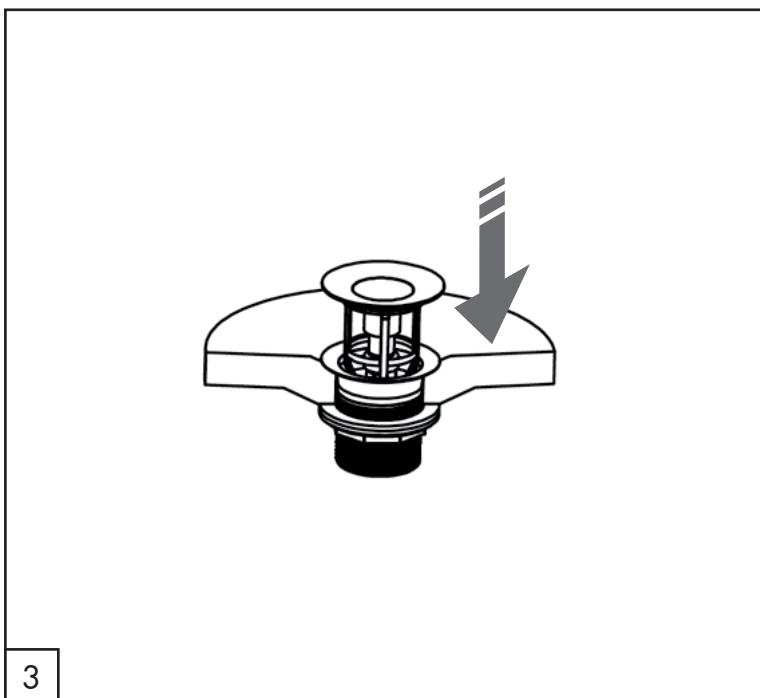
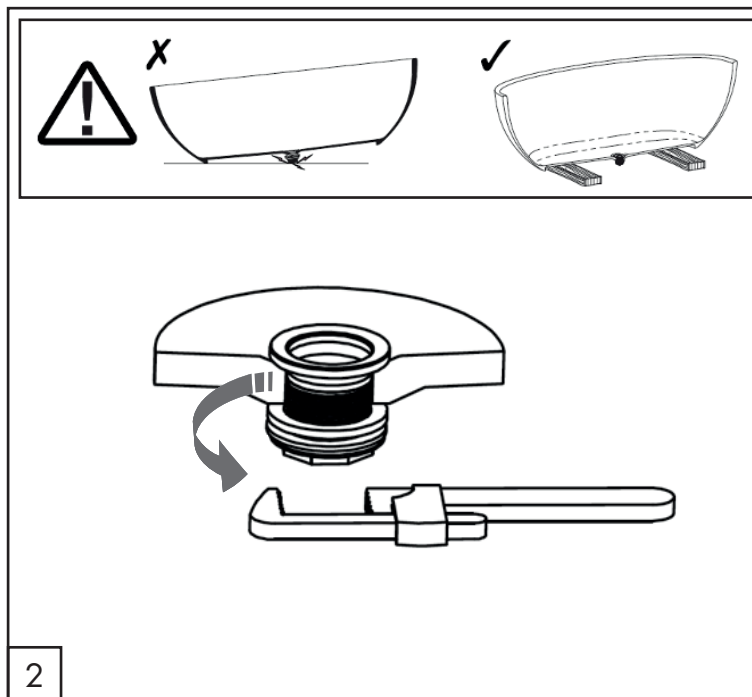
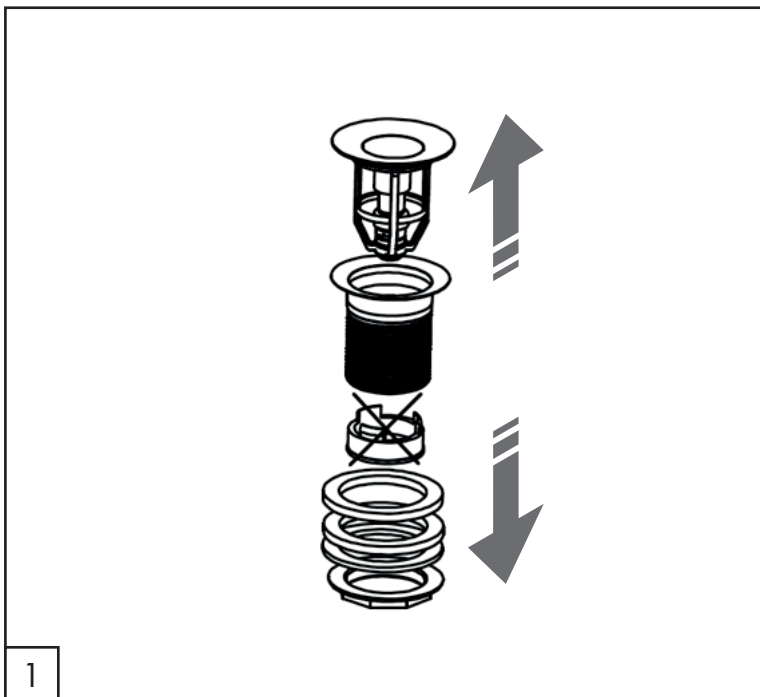

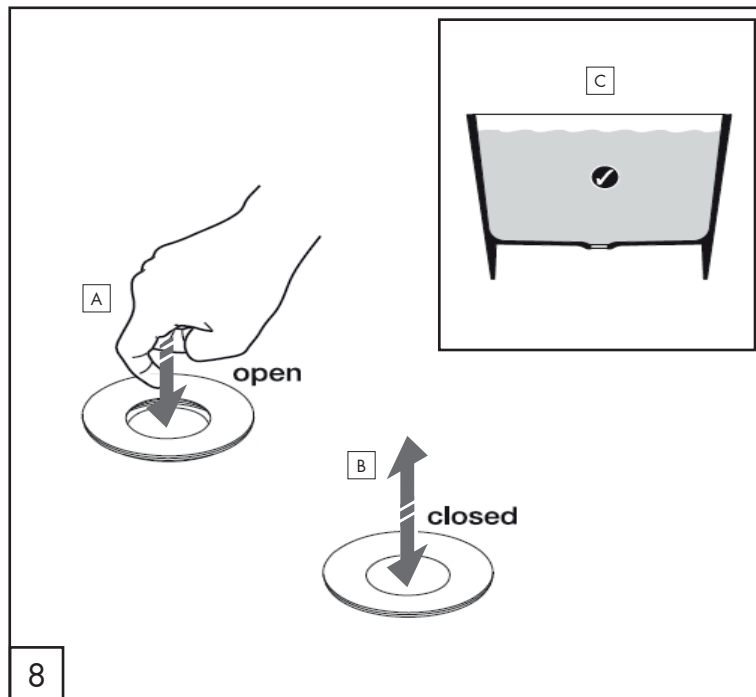
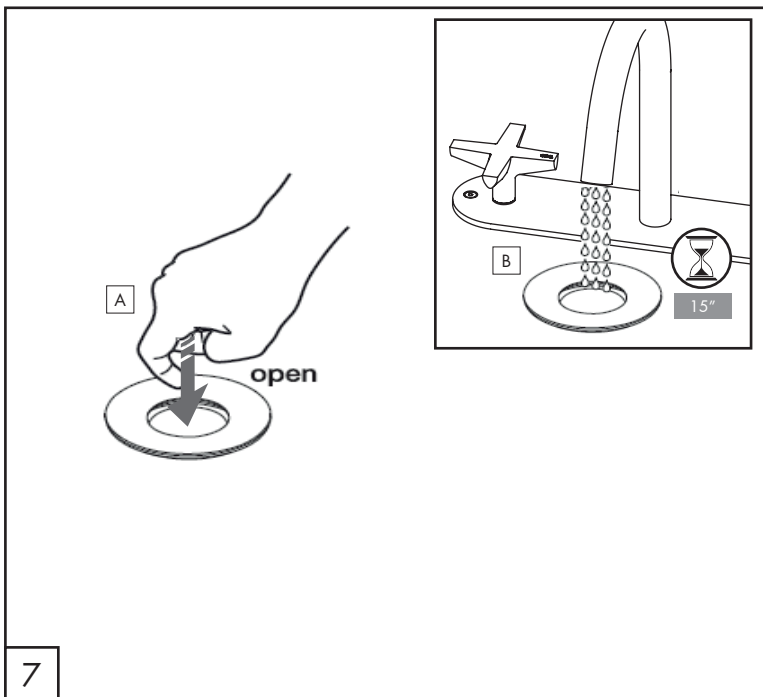
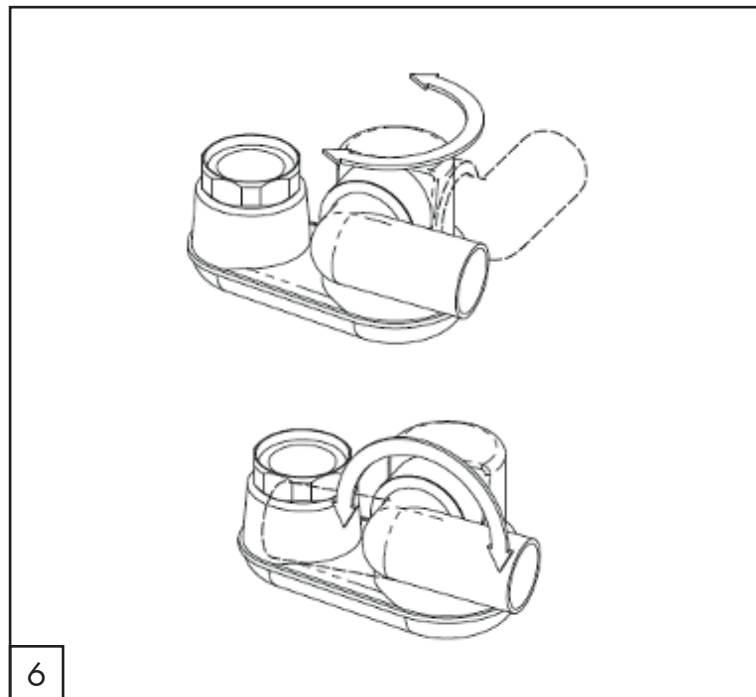
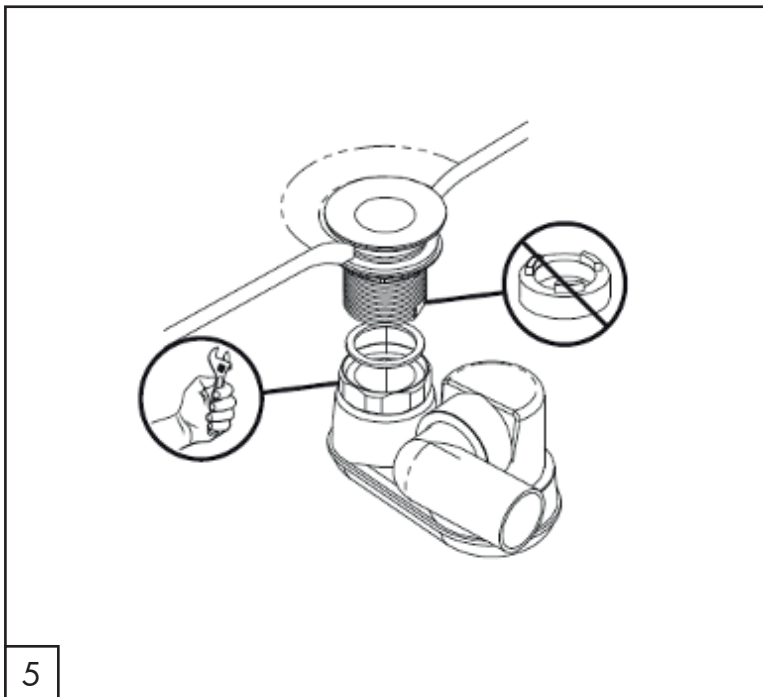

POSIZIONE PULSANTE 1 (BASSO): Apertura piletta cm. 40  
 BUTTON POSITION 1 (DOWN): Waste opening cm. 40

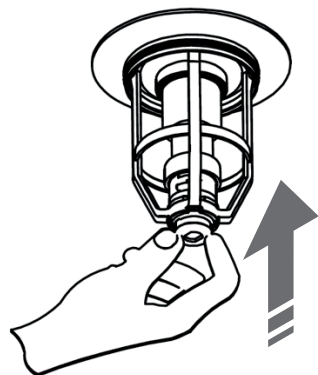

1  Premere il pulsante sul fondo del cestello e ruotarlo in senso orario per portare in posizione 2  
 Press the button at bottom of basket and turn clockwise to bring to position 2

POSIZIONE PULSANTE 2 (ALTO): Apertura piletta cm. 44  
 BUTTON POSITION 2 (UP): Waste opening cm. 44

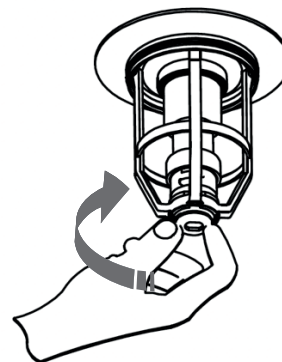

2

## PULIZIA / CLEANING

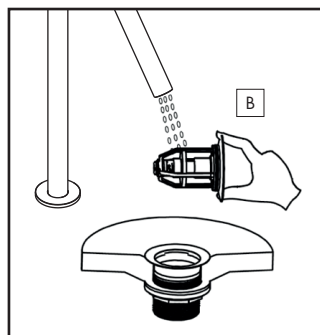
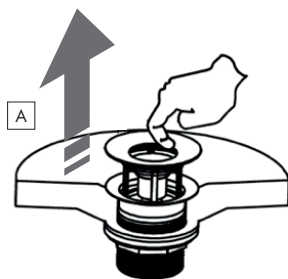

2

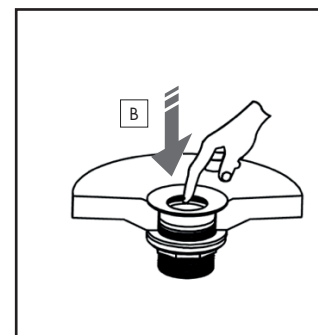
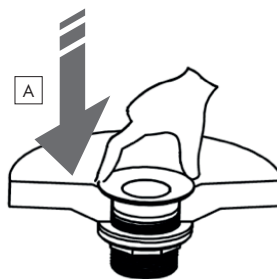

# PIL37

\_REV10

## AVVERTENZE TECNICHE

Pulire con un sapone neutro, applicare con un panno umido, strofinare leggermente, lasciar agire brevemente e quindi sciacquare con acqua. Infine lucidare con un panno morbido e asciutto. Per macchie di calcare pulire con una soluzione di acqua (80%) e aceto bianco (20%), per un'azione igienizzante aggiungere alla soluzione del bicarbonato di sodio. Asciugare sempre la superficie in modo da evitare le macchie derivanti dall'acqua.

La resistenza alla corrosione al nichel-cromo si riduce sotto l'azione di acidi e composti alogenati (cloruri, bromuri, ioduri). Non utilizzare mai soluzioni a base di cloro (candeggina), detersivi o spugne abrasive. Evitare la ruggine causata da materiali esterni (ad es. paglietta di acciaio ecc.).

## TECHNICAL WARNINGS

Clean with a mild soap, apply with a damp cloth, rub lightly, leave it briefly and then rinse with water. Finally polish with a soft, dry cloth. To remove limestone stains, clean with a solution of water (80%) and white vinegar (20%), to sanitize you may add baking soda. Always dry the surface in order to prevent water stains.

Chrome resistance to corrosion is reduced by acids and halogen compounds (chlorides, bromides, iodides).

Never use solutions containing chlorine (bleach), detergents or abrasive sponges. Avoid rust caused by external materials (e.g. steel wool etc.).